



## 9 Dream Court NAMBOUR QLD

3 2 3

Be lured by an idyllic court location with generous spaces ensuring harmonious living for a growing family.

A double garage with internal entry and side gate access... keeping a boat, caravan or extra vehicle just became a lot more convenient.

Step inside Number 9 Dream Court and be pleasantly surprised by the natural toned palette and light and bright interiors. From the media room to the open plan kitchen, living and dining area your family needs are well catered for.

At the far end of the home lies the large air conditioned Master bedroom with walk in robe and neutral coloured ensuite. Off the hall lies the family bathroom, separate toilet and laundry along with 2 colourful bedrooms with ceiling fans and built in robes.

A large oversized covered patio invites easy-breezy alfresco living with handy access from the galley style

**Building Size** : 17 sqm

**Land Size** : 635 sqm

**View** : <https://www.propertylane.com.au/sale/ql/sunshine-coast/nambour/residential/home/7814108>



**Nadina Villani**  
07 5442 1855

# 9 Dream Court, NAMBOUR

3  2  2 

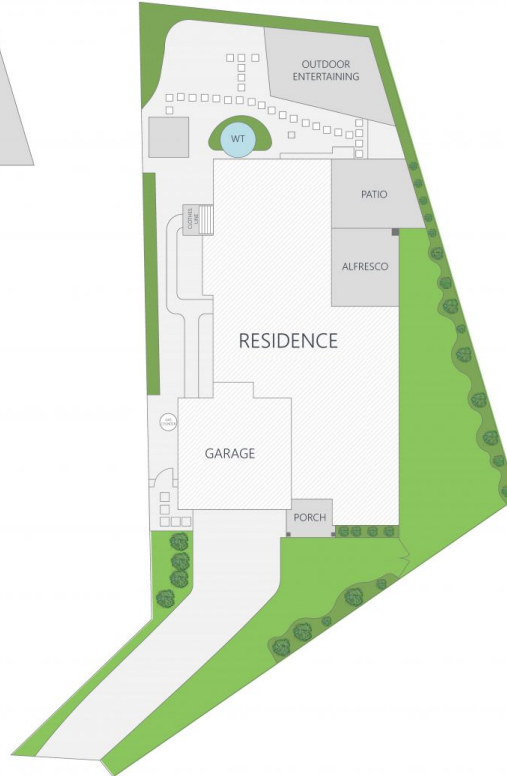

ARTIST'S IMPRESSION ONLY: While every attempt has been made to ensure the accuracy of this floor plan areas and measurements of doors, windows, rooms and all other items are approximate and no responsibility is taken for any error, omission, or mis-statement. This plan is for illustrative purposes only and should only be used as such by any prospective purchaser.

Internal: 124m<sup>2</sup>  
 External: 30m<sup>2</sup>  
 Garage: 33m<sup>2</sup>  
 Total: 175m<sup>2</sup>  
 Land Size: 634m<sup>2</sup>

