



PROPERTYLANE
REALTY



157 Panorama Drive ROSEMOUNT QLD

5 2 1

Step inside and enjoy the tranquil treetop ambience of this thoughtfully renovated residence situated high on picturesque Panorama Drive. The immaculate, split-level brick home sits on a generous 911m2 block and offers five bedrooms, multiple living areas and dual living potential plus abundant al fresco spaces from which to enjoy your lush, leafy surrounds. A stunning Bismarck Palm forms the centrepiece of the huge, fenced yard which has two garden sheds and plenty of space for a pool if you wish and having no rear neighbours (except koalas) you're guaranteed privacy!

Features to note:

- Renovated, split-level brick home on fenced 911m2 block
- Five bedrooms plus multi-purpose room
- Two bathrooms, separate WC, separate laundry

Building Size : 30 sqm
Land Size : 911 sqm
View : <https://www.propertylane.com.au/sale/ql/sunshine-coast/rosemount/residential/house/7814125>



Athena Law
07 5442 1855

<https://www.propertylane.com.au>

5  2  1 

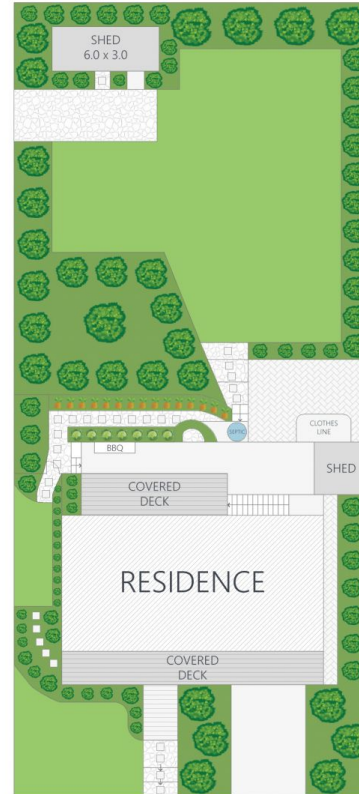

ARTIST'S IMPRESSION ONLY: While every attempt has been made to ensure the accuracy of this floor plan areas and measurements of doors, windows, rooms and all other items are approximate and no responsibility is taken for any error, omission, or mis-statement. This plan is for illustrative purposes only and should only be used as such by any prospective purchaser. By RealEstateFloorPlans.com.au

Internal: 184m²
External: 53m²
Garage: 39m²
Total: 276m²
Land Size: 911m²

