



PROPERTYLANE
REALTY



14 Laurel Avenue NAMBOUR QLD

4 3 2

Nestled within a quiet cul-de-sac, this enchanting period-style residence exudes both charm and character, providing an ideal sanctuary for families. The expansive layout flawlessly integrates the interior living spaces with the covered external deck and patio, enticing you to step into the fully fenced backyard and enjoy the outdoor surroundings.

Upon entry, you'll be embraced by the welcoming ambiance of a genuine family home. Bathed in natural light and offering treetop vistas, the airy living room serves as the heart of the abode. The polished timber flooring throughout the living areas, fretwork, and French doors that unfold onto the extensive covered deck, all contribute to its appeal. Countless hours of relaxation and joyous

Type : House
Land Size : 1214 sqm
View : <https://www.propertylane.com.au/sale/qld/sunshine-coast/nambour/residential/house/7814163>



Amanda Morton
07 5442 1855

[For full version visit the website](https://www.propertylane.com.au)

<https://www.propertylane.com.au>

4  3  2 

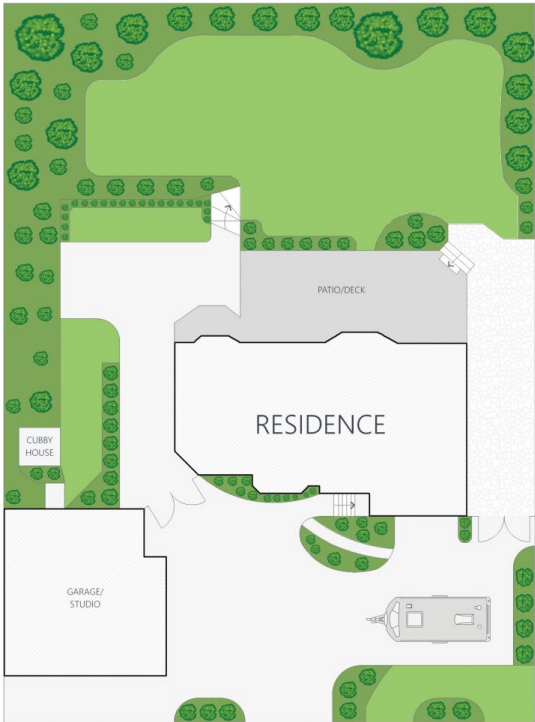

ARTIST'S IMPRESSION ONLY: While every attempt has been made to ensure the accuracy of this floor plan areas and measurements of doors, windows, rooms and all other items are approximate and no responsibility is taken for any error, omission, or mis-statement. This plan is for illustrative purposes only and should only be used as such by any prospective purchaser. By RealEstateFloorPlans.com.au

Internal:	140m ²
External:	70m ²
Grage/Studio:	112m ²
Total:	322m ²
Land Size:	1,214m ²

