



46 Smith Road KUREELPA QLD

3 2 6

This stunning natural wonderland of nearly 15 acres offers a unique lifestyle opportunity in a tranquil and secluded bush setting. Smith Road is an enchanting country lane which leads you past cattle grazing in lush fields and across trickling creeks, then as you enter the property itself via the long sealed driveway you'll feel transported to a more peaceful world altogether. Nature lovers will appreciate that this property backs onto a wildlife conservation area which adjoins National Parks and State Forest, so expect to share your new home with rock wallabies, bandicoots, echidnas and a plethora of colourful birdlife!

- Architecturally designed, well-maintained home circa 1996
- Three light & bright bedrooms, master with WIR, ensuite, aircon & private deck

Building Size : 29 sqm
Land Size : 57870 sqm
View : <https://www.propertylane.com.au/sale/qld/sunshine-coast/kureelpa/residential/acreagesemirural/7814178>



Athena Law
07 5442 1855

46 Smith Road, KUREELPA

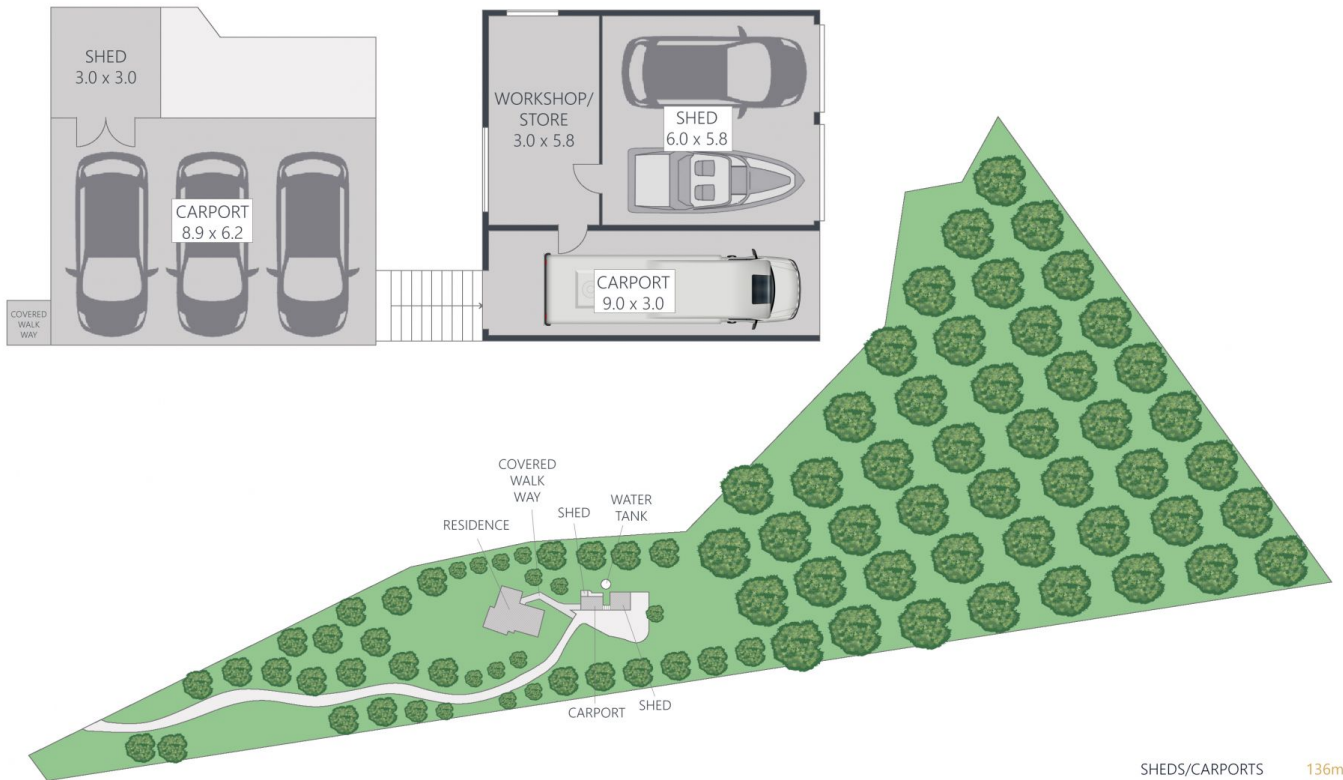

SHEDS/CARPORTS 136m²
 APPROX LAND SIZE 14.3 Acres



ARTIST'S IMPRESSION ONLY: While every attempt has been made to ensure the accuracy of this floor plan areas and measurements of doors, windows, rooms and all other items are approximate and no responsibility is taken for any error, omission, or mis-statement. This plan is for illustrative purposes only and should only be used as such by any prospective purchaser. By RealEstateFloorPlans.com.au



46 Smith Road, KUREELPA



Internal 209m²
 External 62m²
 Total 271m²



ARTIST'S IMPRESSION ONLY: While every attempt has been made to ensure the accuracy of this floor plan areas and measurements of doors, windows, rooms and all other items are approximate and no responsibility is taken for any error, omission, or mis-statement. This plan is for illustrative purposes only and should only be used as such by any prospective purchaser. By RealEstateFloorPlans.com.au

