



14 Kooyonga Court NAMBOUR QLD

3 1 2

Standing proudly on the high side of this charming cul-de-sac, with panoramic views of the Blackall Range, this delightful residence offers both space and potential. With three double bedrooms, open plan living and a sunny front verandah to soak in the vista, you'll love the bonus space downstairs with windows, power and ceiling of legal building height, here's your potential fourth bedroom or rumpus. The large, fenced 878m² block has been thoughtfully landscaped with terraced grassed areas for the kids to play, and the perfect spot for a pool.

- Ideal cul-de-sac location with views
- Generous 878m² block with fenced backyard
- Three bedrooms with family bathroom

Building Size : 23 sqm
Land Size : 878 sqm
View : <https://www.propertylane.com.au/sale/qld/sunshine-coast/nambour/residential/home/7814307>



Athena Law
07 5442 1855

3 1 2

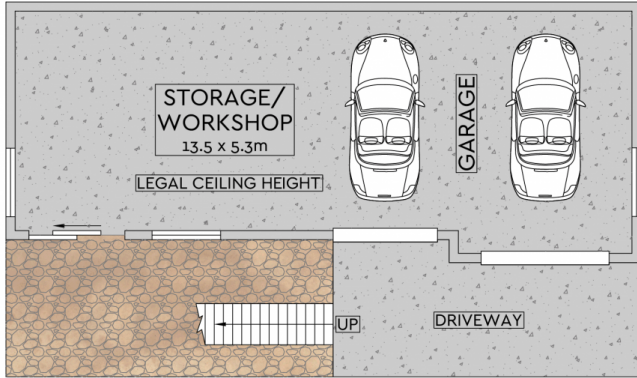

TOTAL AREA : 213 m²

0 1 2 3 4 5

Scale in metres. We give no guarantee, warranty or representation as to the accuracy and completeness of the floor plan. We recommend that you instruct your own surveyor to carry out an independent investigation of the property prior to relying on the accuracy and completeness of this plan. Floor Plan presented by The Floor Plan Specialist. www.thefloorplanspecialist.com.au

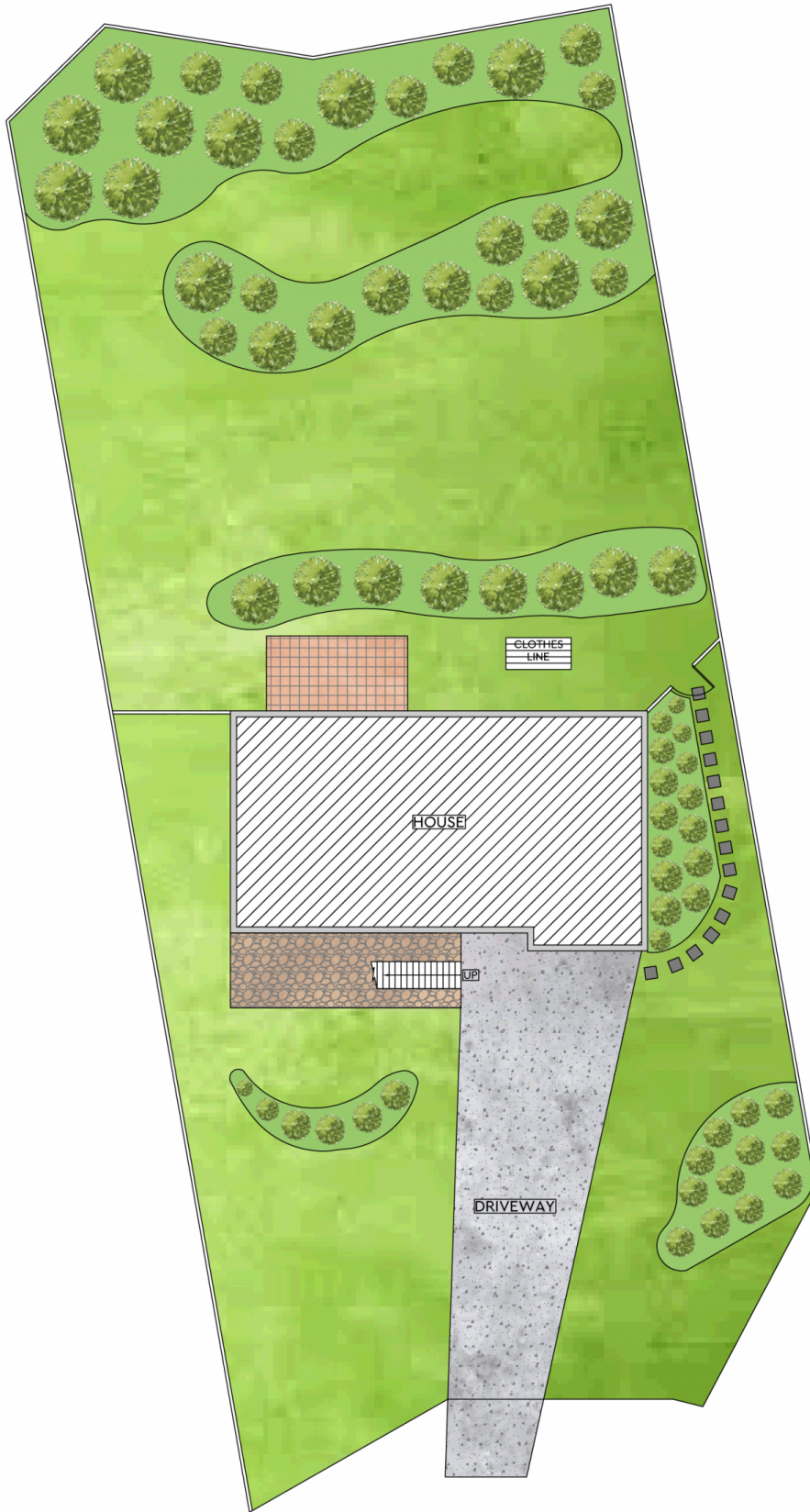

LAND TOTAL : 878 m²

0 1 2 3 4 5