



## 4 Bimbadean Circuit Southside QLD

3 2 2

Situated atop an elevated block close to all of Southside Gympie conveniences, this home takes advantage of the adjoining nature reserve with views from the expansive main living area. The brand-new modern home with soaring ceilings is a unique design built to maximise openness and space and to capture cooling breezes.

Embracing the outdoors through walls of glass sliding doors and louvres, the living areas are open to exposed aggregate alfresco pads, perfect for entertaining. The crisp white kitchen is furnished with a huge island benchtop, soft close drawers, cupboard doors and stainless-steel appliances, all with the home chef in mind!

This home will be a delight to live in with its functional

[For full version visit the website](https://www.propertylane.com.au/sale/qld/southside/residential/house/8095822)

**Type** : House  
**Price** : \$ 725,000  
**Land Size** : 728 sqm  
**View** : <https://www.propertylane.com.au/sale/qld/southside/residential/house/8095822>



**Barry Mitchell**  
0400730818



**Nadina Villani**  
07 5442 1855

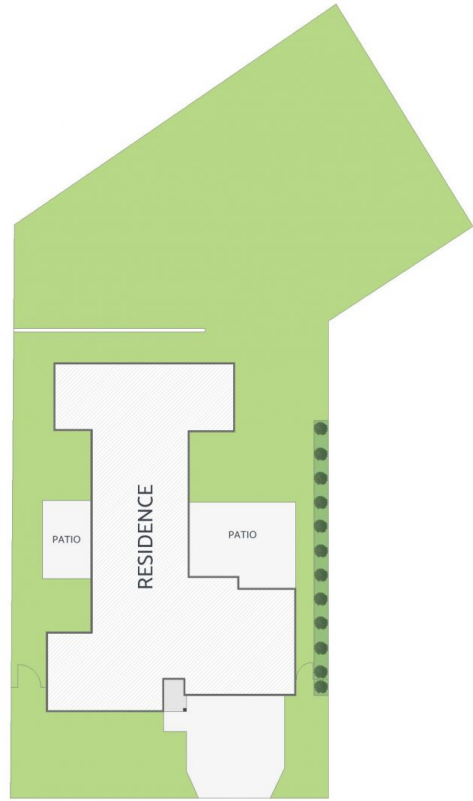

## 4 Bimbadean Circuit, SOUTHSIDE

ARTIST'S IMPRESSION ONLY: While every attempt has been made to ensure the accuracy of this floor plan's areas and measurements of doors, windows, rooms and all other items are approximate and no responsibility is taken for any error, omission, or mis-statement. This plan is for illustrative purposes only and should only be used as such by any prospective purchaser. Floor Plan by: [RealEstateFloorPlans.com.au](http://RealEstateFloorPlans.com.au)



TOTAL: 165m<sup>2</sup>  
LAND SIZE: 728m<sup>2</sup>

3   
2   
2 

 **PROPERTYLANE**  
REALTY