



2 Burruma Court Coes Creek QLD

3 1 3

Nestled on a generous 946m² block, this delightful, highset home boasts an elevated corner position with north-easterly views toward Rosemount and Mt Coolum. Surrounded by lush gardens, this well-maintained property offers both space and potential.

Upstairs, you'll find three comfortable bedrooms, a central kitchen, and a welcoming living area with polished timber floors that seamlessly opens onto a lovely deck - ideal for soaking up the views and enjoying those refreshing summer breezes. Downstairs, the rumpus room with cosy fireplace, plus an additional multipurpose room, creates a versatile space for entertainment, or a dedicated area for your home office.

Type	: House
Price	: Buyers in the Mid \$700,000's
Building Size	: 307 sqm
Land Size	: 946 sqm
View	: https://www.propertylane.com.au/sale/ql/sunshine-coast/coes-creek/residential/house/8140082



Athena Law
07 5442 1855

[For full version visit the website](https://www.propertylane.com.au)

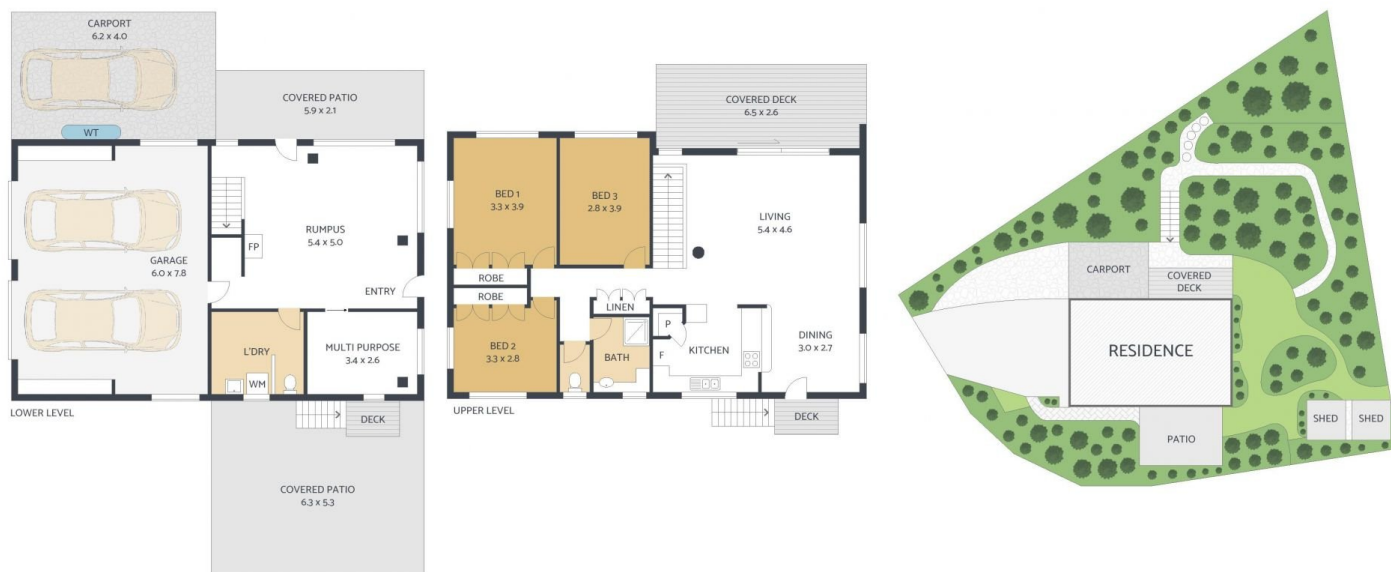

2 Burruma Court, COES CREEK

ARTIST'S IMPRESSION ONLY: While every attempt has been made to ensure the accuracy of this floor plan's areas and measurements of doors, windows, rooms and all other items are approximate and no responsibility is taken for any error, omission, or mis-statement. This plan is for illustrative purposes only and should only be used as such by any prospective purchaser. **Floor Plan by: RealEstateFloorPlans.com.au**



INTERNAL:	155m ²
EXTERNAL:	65m ²
GARAGE/CARPORT:	72m ²
TOTAL:	307m ²
LAND SIZE:	946m ²

3	
1.5	
3	



PROPERTY LANE
REALTY