



## 39 Flaxton Drive Mapleton QLD

3 2 4

Nestled in the heart of Mapleton, this solid brick home offers a rare opportunity to enjoy the best of Sunshine Coast hinterland living with sweeping 180-degree coastal views.

Lovingly owned for over three decades, the home sits at the start of the Blackall Range, providing a peaceful escape while still being just a 15-minute drive to Nambour and 10 minutes to Montville.

Imagine waking up to the sight of the sun rising over the water, enjoying your morning coffee on the deck, and spending cozy winter nights by the fireplace.

With high raked ceilings, charming architectural details, and

[For full version visit the website](https://www.propertylane.com.au/sale/qld/sunshine-coast/mapleton/residential/house/8181252)

**Type** : House  
**Price** : Buyers From \$1,150,000  
**Building Size** : 295 sqm  
**Land Size** : 961 sqm  
**View** : <https://www.propertylane.com.au/sale/qld/sunshine-coast/mapleton/residential/house/8181252>



**Megan Manly**  
07 5442 1855



**William Emms**  
07 5442 1855

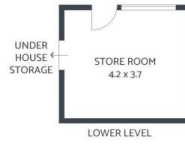

## 39 Flaxton Drive, MAPLETON

ARTIST'S IMPRESSION ONLY: While every attempt has been made to ensure the accuracy of this floor plan's areas and measurements of doors, windows, rooms and all other items are approximate and no responsibility is taken for any error, omission, or mis-statement. This plan is for illustrative purposes only and should only be used as such by any prospective purchaser. Floor Plan by: [RealEstateFloorPlans.com.au](http://RealEstateFloorPlans.com.au)



INTERNAL: 170m<sup>2</sup>  
 EXTERNAL: 80m<sup>2</sup>  
 GARAGE: 45m<sup>2</sup>  
 TOTAL: 295m<sup>2</sup>  
 LAND SIZE: 961m<sup>2</sup>

3   
 2   
 4

**PROPERTY LANE**  
 REALTY